

286 Dual Point Aluminium Lock

Brio Australia

P: +61 2 87186718

W: brio.com.au

E: brio.sales@allegion.com

Brio UK

P: +44 191 2291224

W: briouk.com

E: brio.sales.uk@allegion.com

Brio USA

P: +1 585 3195599

W: briousa.com

E: brio.sales.usa@allegion.com

Codes

286 L - 25 D PBK

Handle Finish: PBK (Black), PR (Physical Vapour Deposition Black), SN (Satin Nickel), SS (Satin Stainless)

Tip Type: D (Stainless Steel D-Tip)

Rod Set Length: 25 (1.5 & 1m Rods for 2.5m panels), 35 (2.5 & 1m Rods for 3.5m panels)

Handle Type: L (Locking Handle with 30/10 Cylinder), N (Non-Locking Handle)

Dual Point Lock

Components no finishes shown.

ALUMINIUM LOCK BODY
286A



NON-LOCKING HANDLE
286N

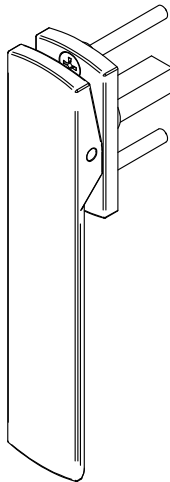

LOCKING HANDLE
286L-40

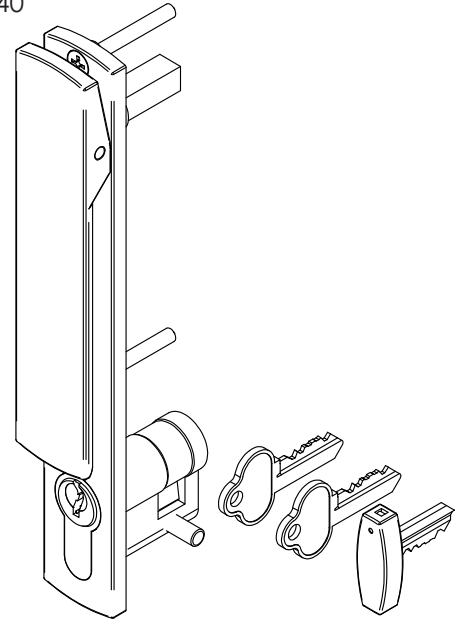

Rod packs

286-25D

286-35D

ALUMINIUM Ø8[0.315"] ROD & D-TIP ASSEMBLY	1x 1.5m 1x 1.0m	1x 2.5m 1x 1.0m
D-TIP GUIDE	2	2
SCREW PACK	1	1
SPACERS	1	1
DRESS PLATE	2	2
DRILLING JIG & DRILL BIT	1	1

Door Hardware Set Orientation

DL = Dual Point Lock, LK = Lock, left systems shown

OUTWARD OPENING

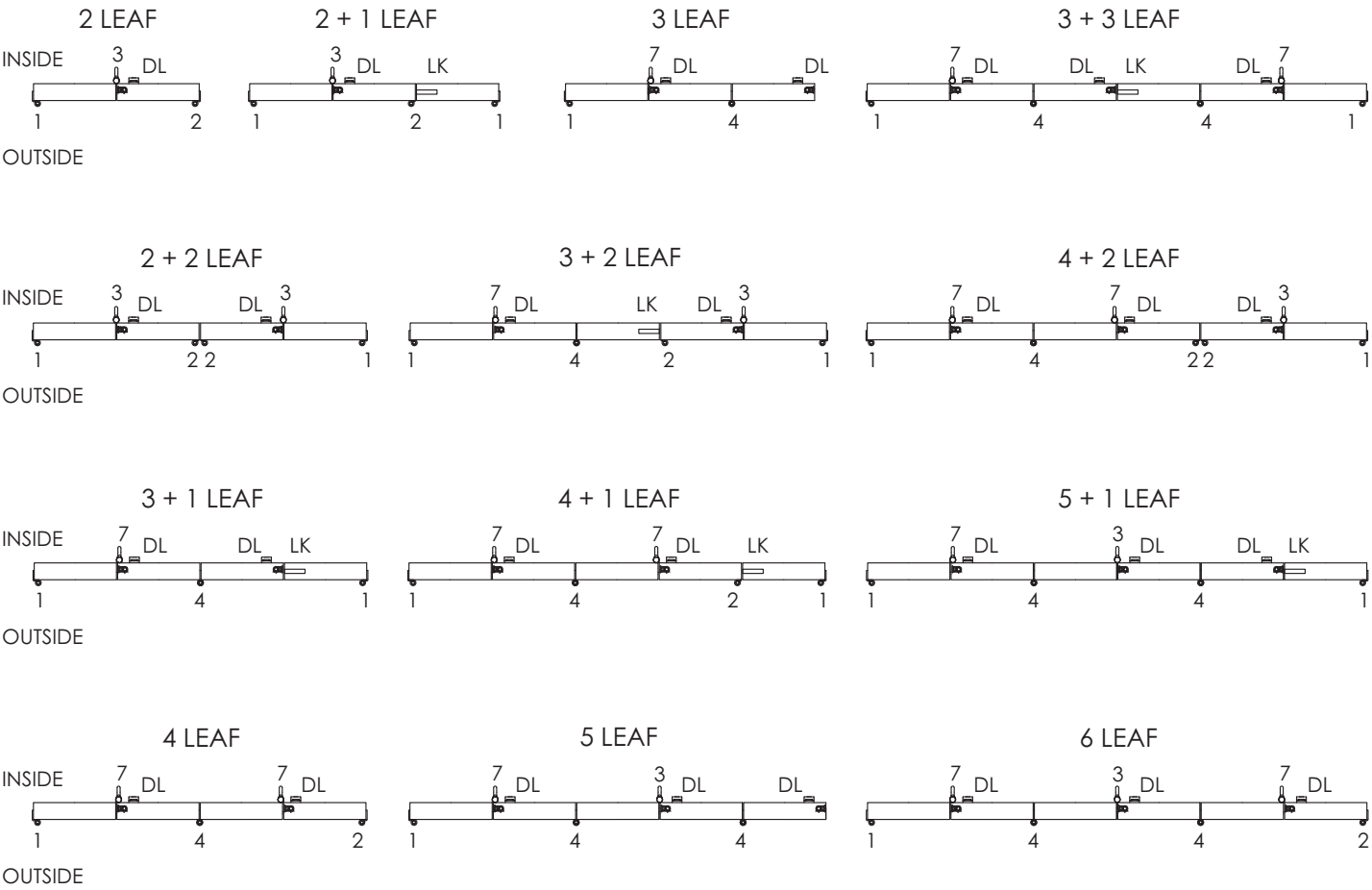

INWARD OPENING

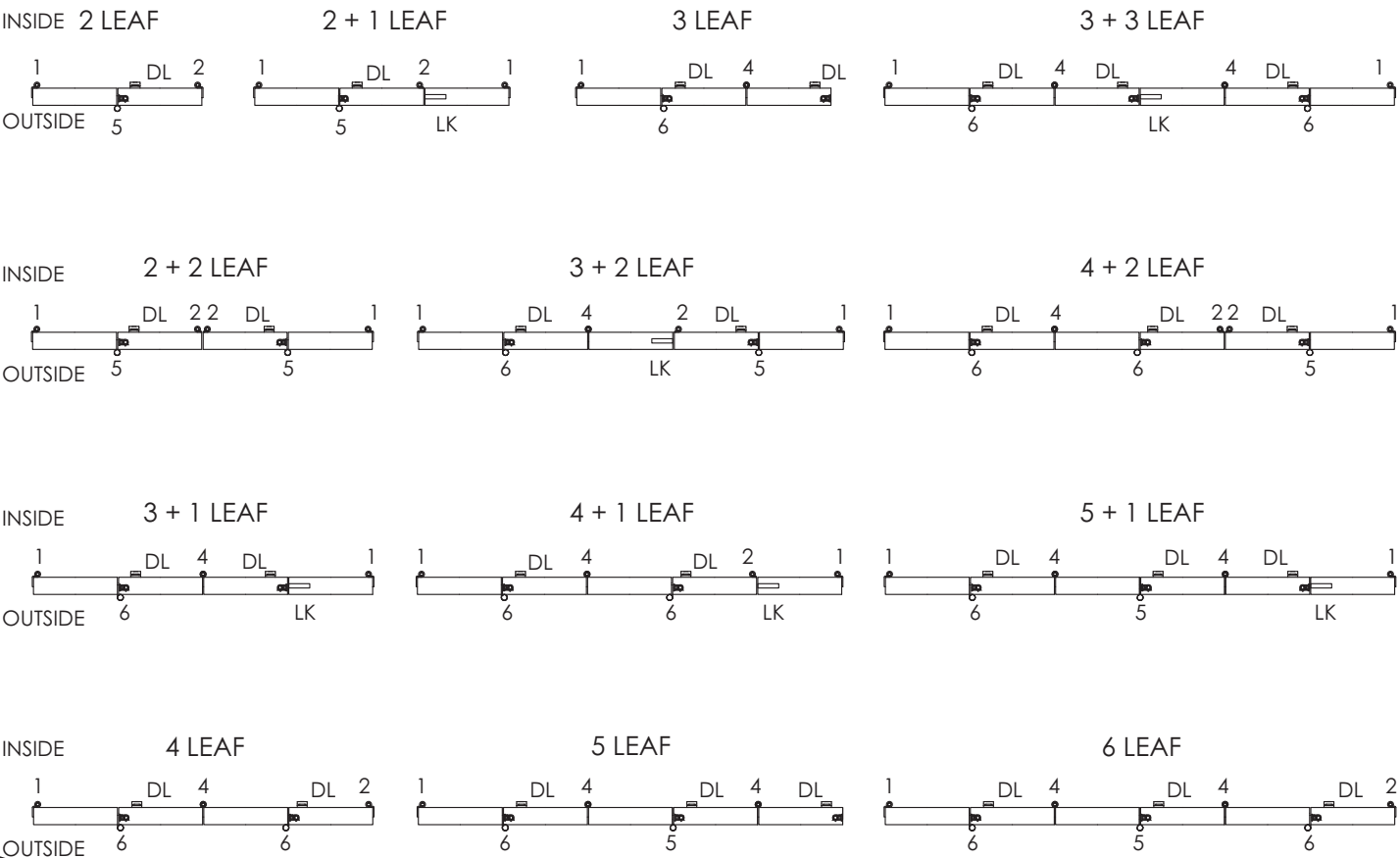

Panel Machining

Non-Locking

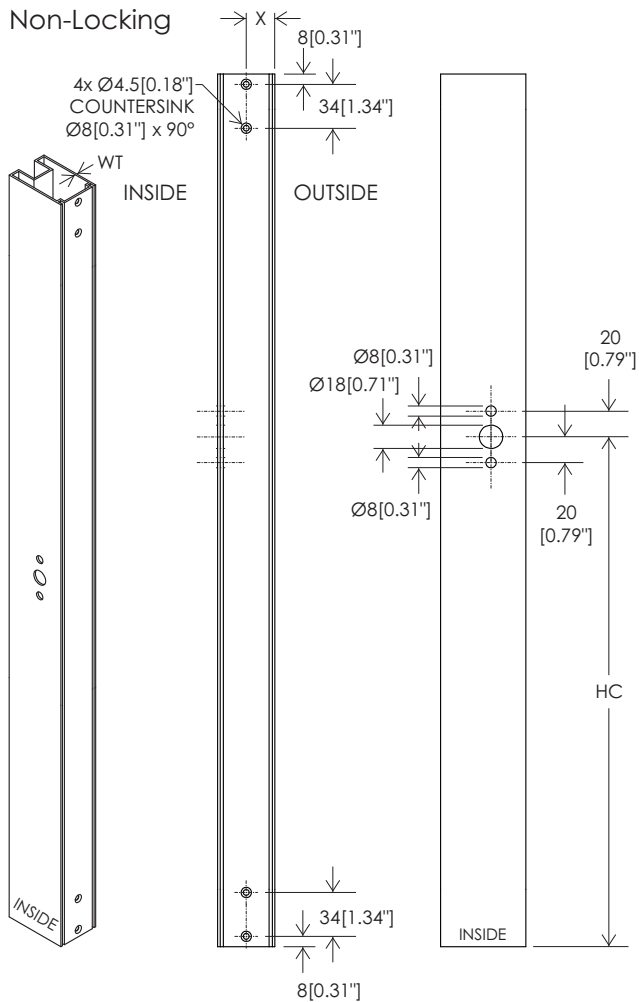

HC = Handle pivot centre
X = PT - 30[1.18"]

Locking

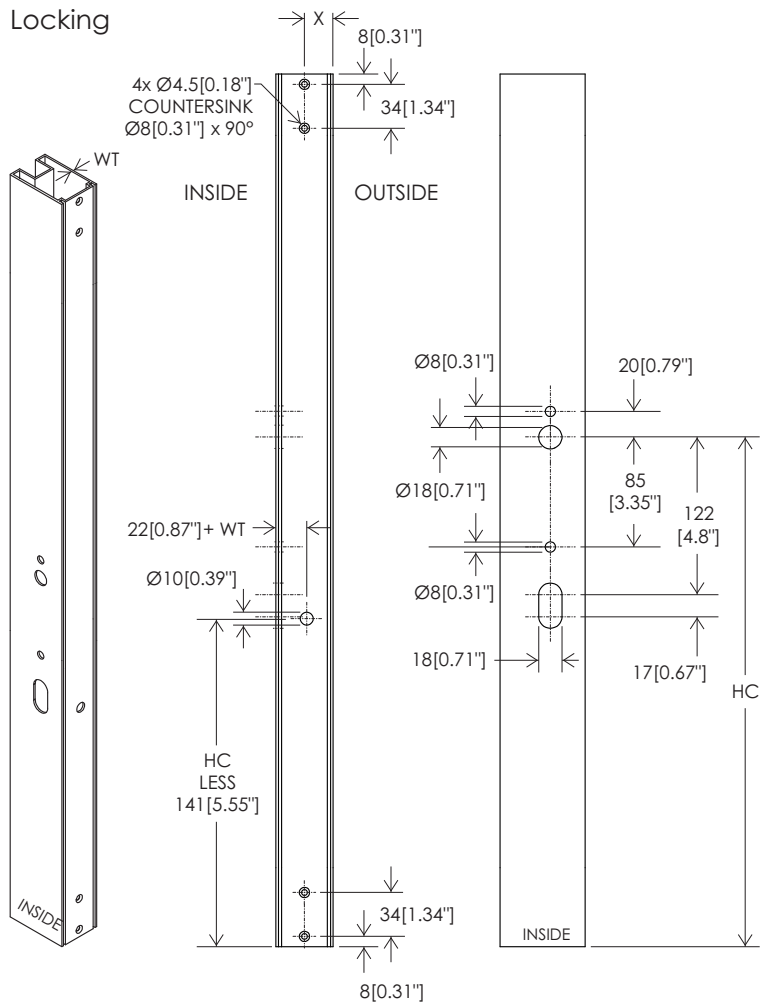

HC = Handle pivot centre
WT = Wall thickness
X = PT - 30[1.18"]

Prepare rods & tip guides

rod drilling jigs & drill bit supplied.

Cut rods

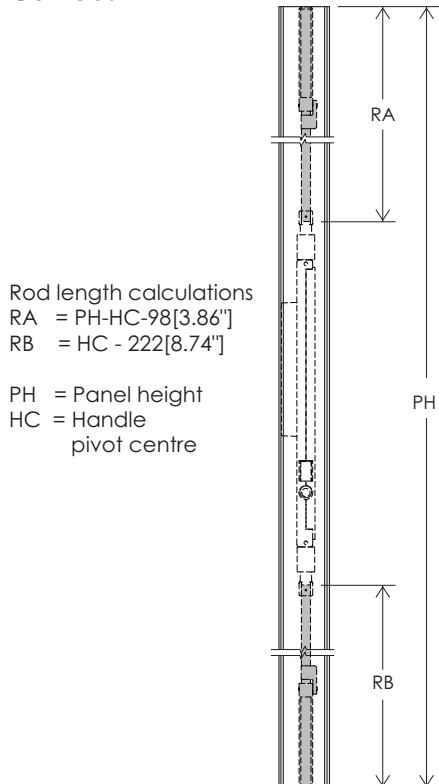

Rod length calculations
RA = PH - HC - 98[3.86"]
RB = HC - 222[8.74"]
PH = Panel height
HC = Handle pivot centre

Drill fixing holes in rod ends

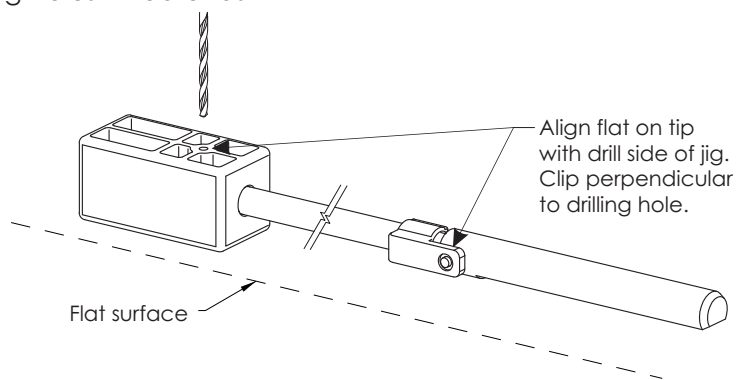

Note: Rods must bottom out in jig to ensure holes are in correct positions

Drill fixing holes in tip guides

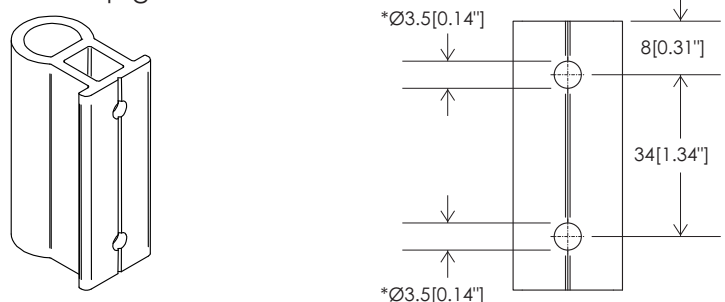

Note:
*Ø3.5[0.14"] hole size critical for self tapping screws

Orientation

tabs on side of lock body are always positioned away from glass.

Left opening

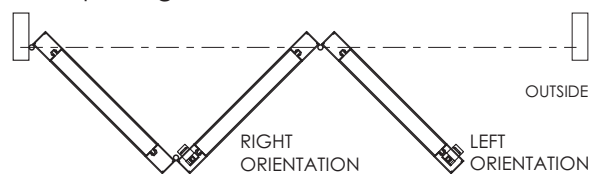

Right orientation

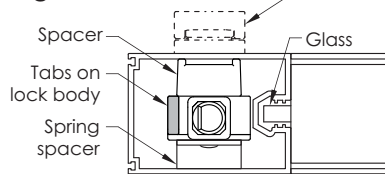

Left orientation

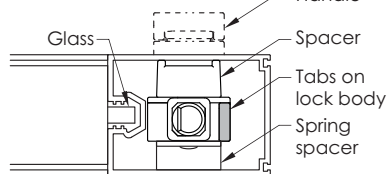

Press spacers onto body

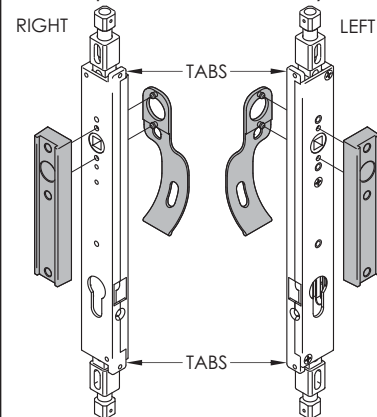

Assembly & Installation

left orientation, locking handle shown.

Insert rod & tip assemblies into lock. Fix with pin clips provided

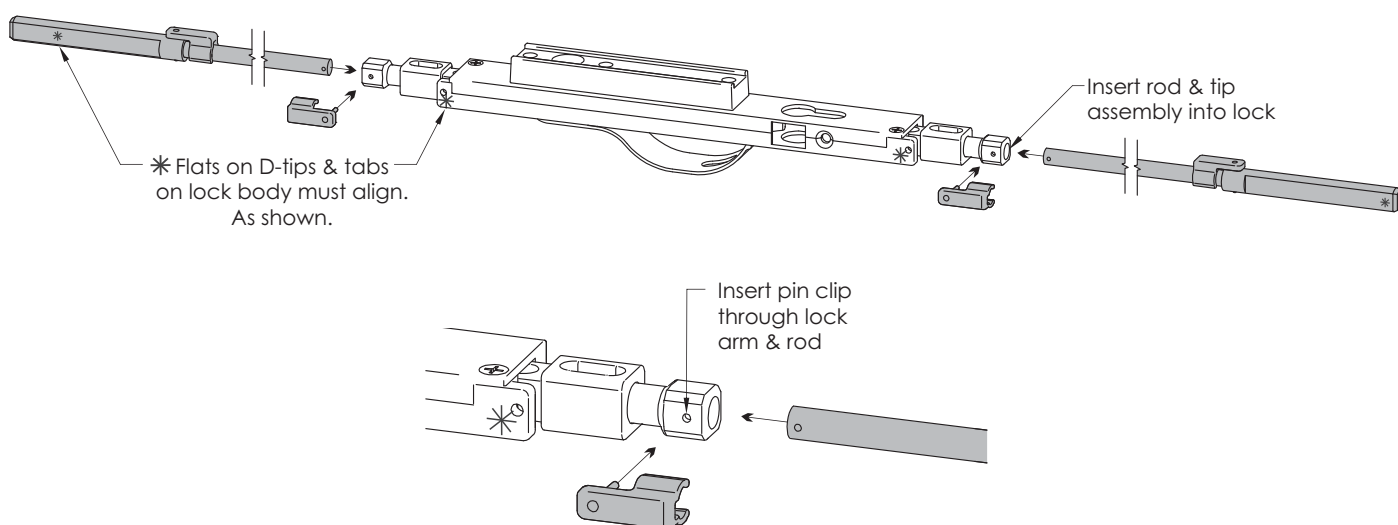

Insert lock assembly

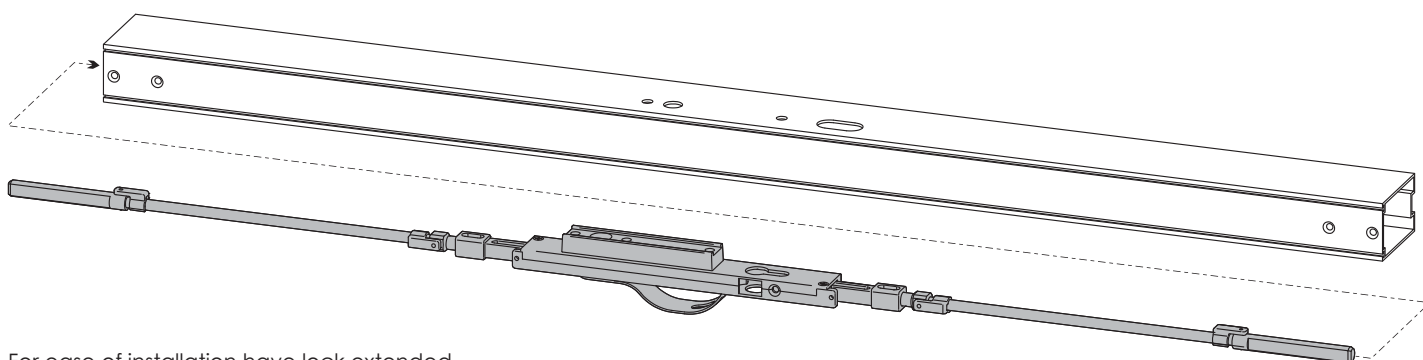

For ease of installation have lock extended

Place handle

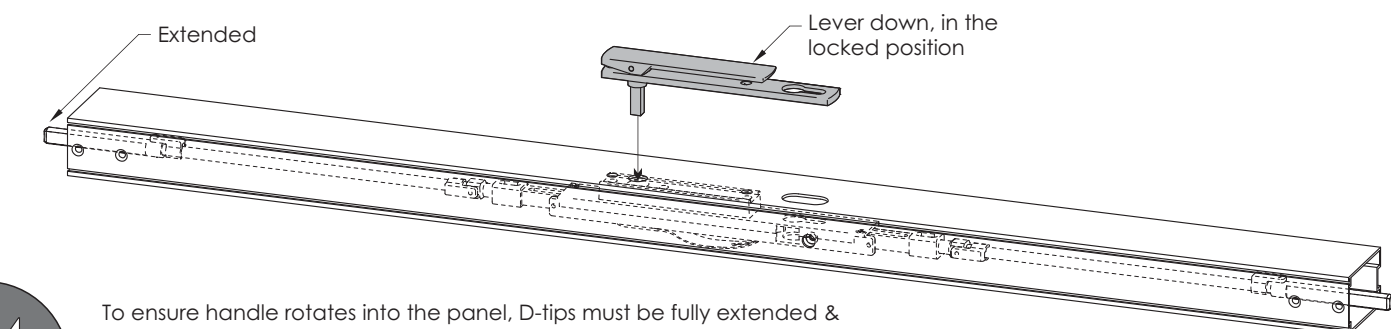

To ensure handle rotates into the panel, D-tips must be fully extended & handle placed with the lever in the down position.

Assembly & Installation continued.

Rotate handle 90° into the panel & fix to lock

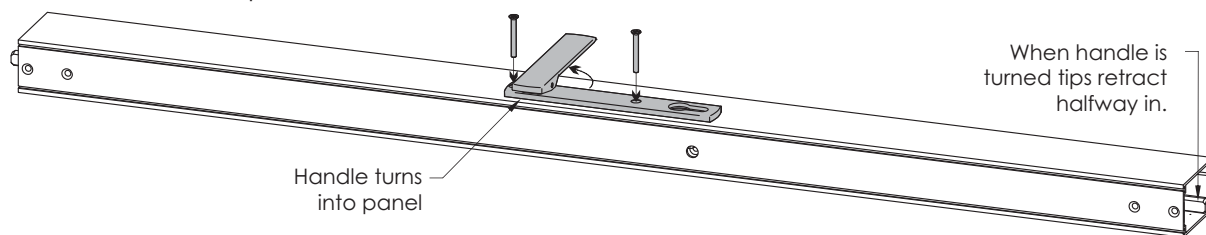

Fit euro cylinder & dress access hole

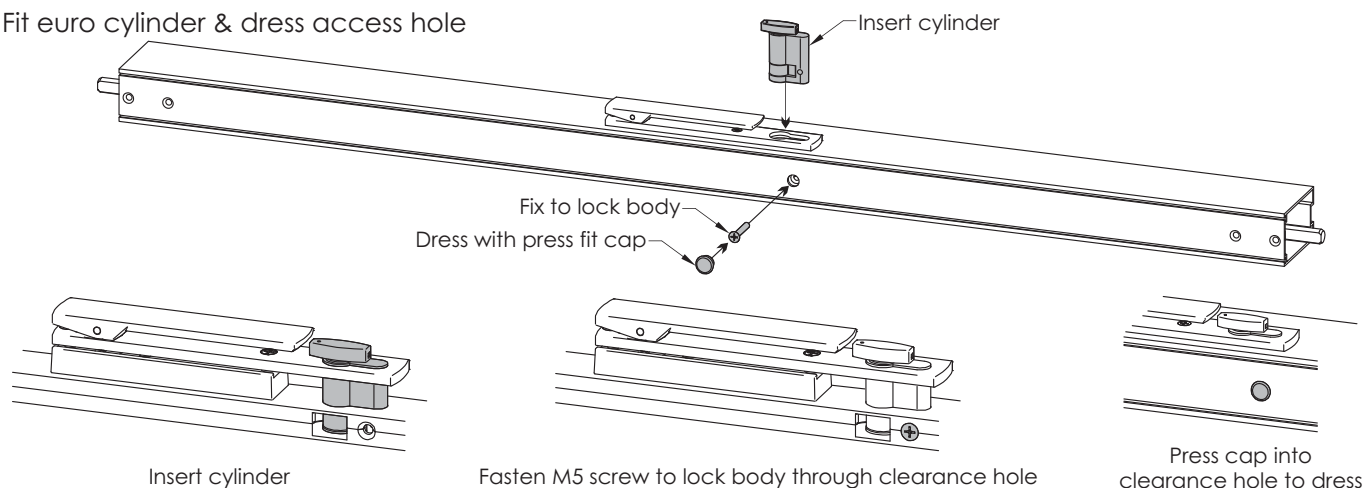

Adjust
Tips

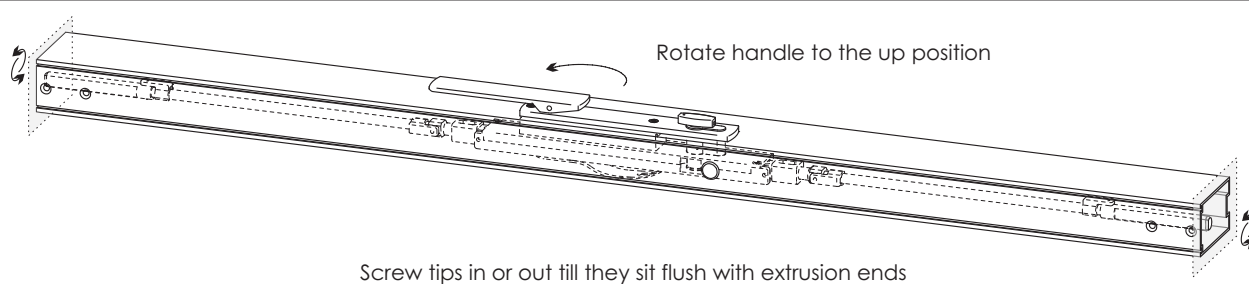

Fix tip guides

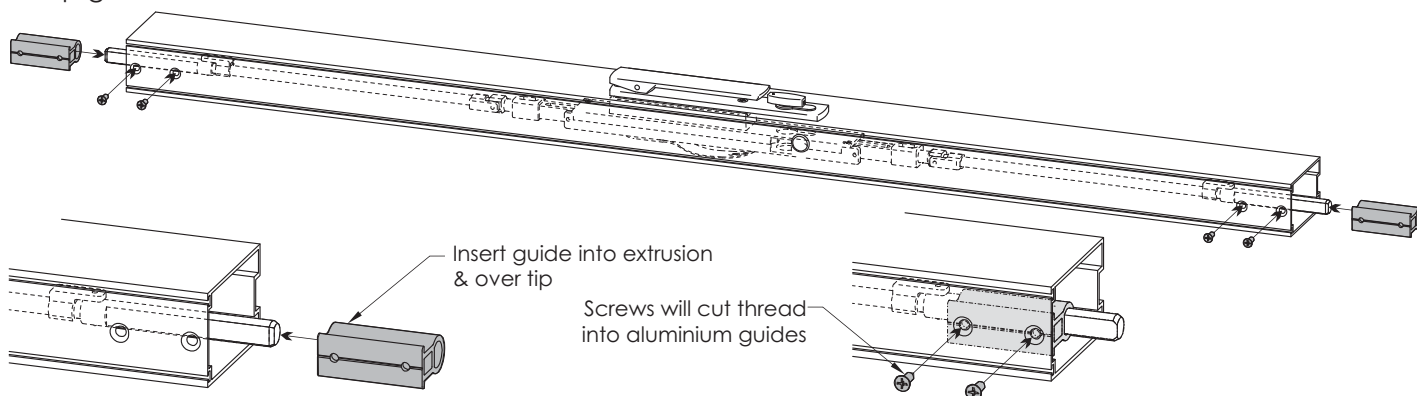

Install keeper plate

Mark where
throw strikes

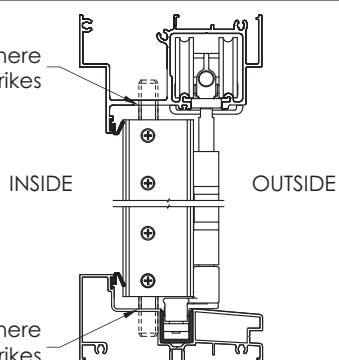

Drill clearance hole and screw keeper
dress plate in position

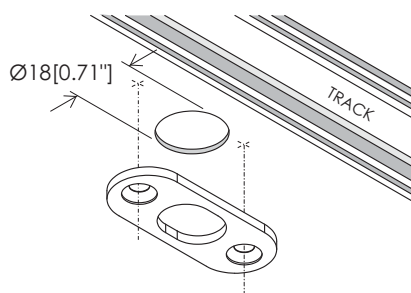

Drill clearance hole and screw keeper
dress plate in position

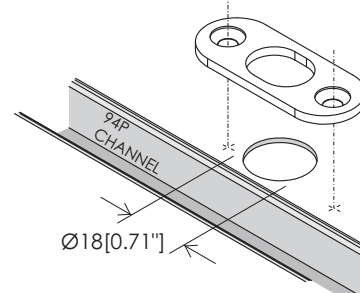

Overview

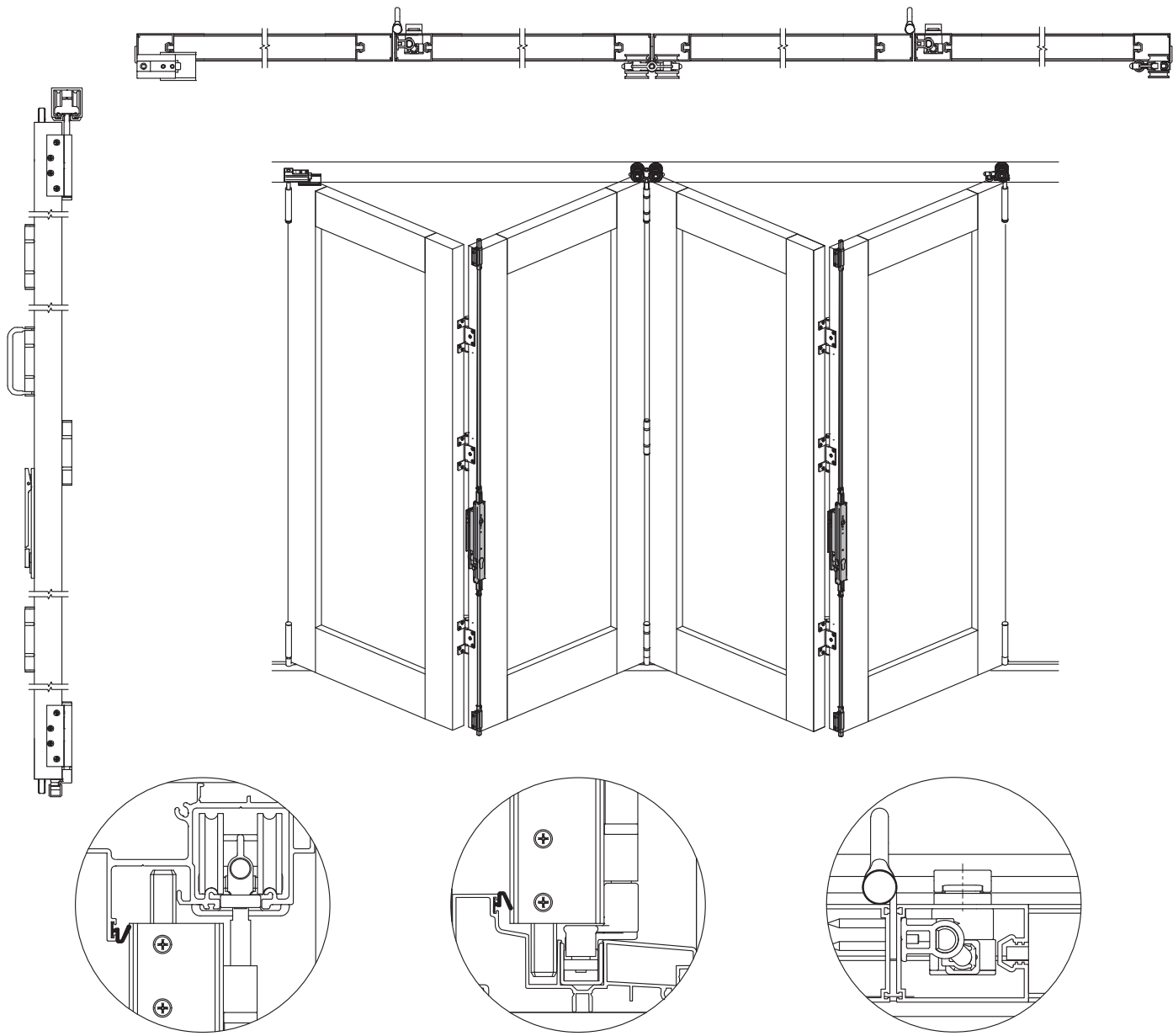

LOCKING

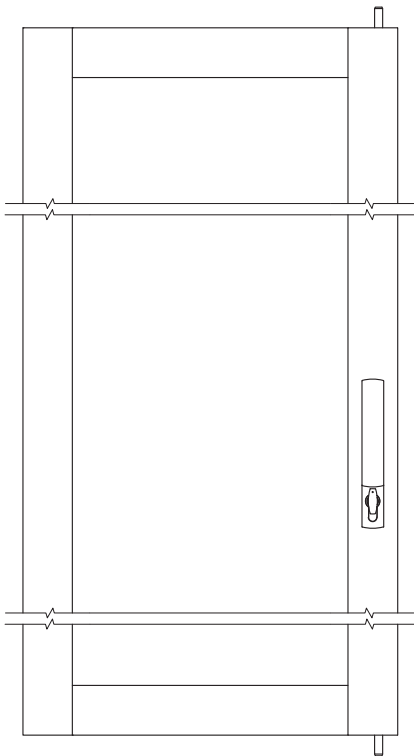

NON-LOCKING

